



SLAMP®
THE LEADING LIGHT

NUVEM
MODULAR SUSPENSION SYSTEM



VISIONARY
ADAPTABLE
SENSUAL
MYSTERIOUS
INNOVATIVE
ACCESSIBLE
RELIABLE
ASPIRATIONAL
ORIGINAL
RESOURCEFUL
EXPERIMENTAL
SUGGESTIVE
HANDMADE

100% HANDMADE IN ITALY

Slamp has been at the forefront of creating original, eclectic, and contemporary lamps since 1994. Each is handcrafted from unique materials in its atelier located in Rome, Italy, in collaboration with internationally renowned architects and designers. Every lamp is recognizable and original thanks to unique, unbreakable technopolymers, sculpted into three dimensional shapes, decorations and effects that would be impossible using any other material.

Dal 1994, Slamp è leader nella creazione di lampade di design originali, eclettiche e contemporanee, realizzate a mano nell'atelier di Roma (Italia), utilizzando materiali unici e collaborando con i più noti architetti e designer internazionali. Unicità e riconoscibilità di ogni lampada passano attraverso l'uso di tecnopolimeri unici, nobili e infrangibili che permettono di realizzare forme, decori ed effetti altrimenti impossibili con altri materiali.

SLAMP®
THE LEADING LIGHT

NUVEM

MODULAR SUSPENSION SYSTEM

design by
MIGUEL ARRUDA



Single module size /

102 x 94 x h. 6 cm
39-3/4 x 36-1/2 x h 2-1/4"

Multiple, square meter
modules with
bidirectional spotlights
can be combined
in infinite combinations



Left: example of a residential installation.

Below: the bottom of a single module.

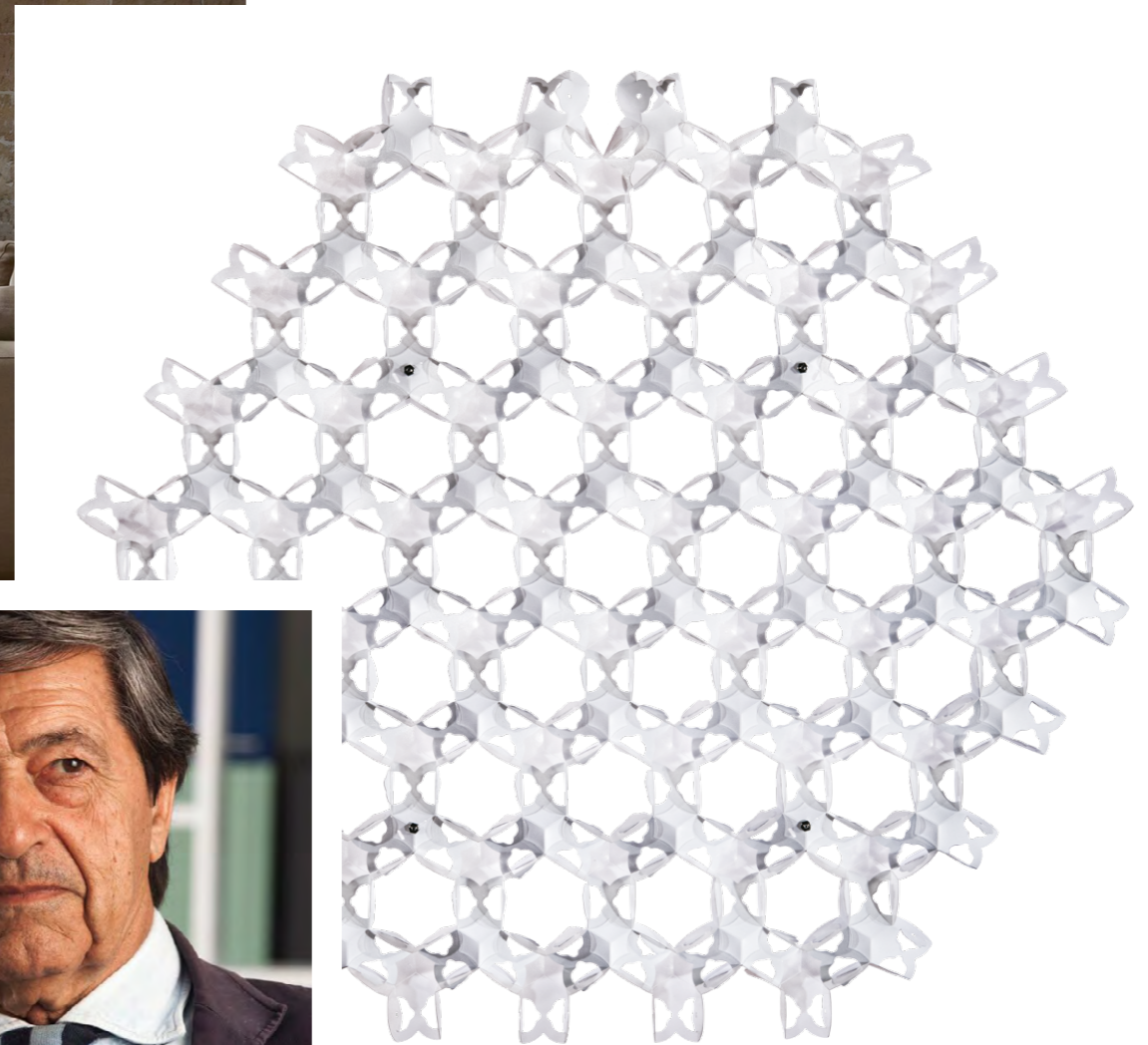

CREATE INFINITE COMPOSITIONS

FROM ONE SQUARE METER TO INFINITY;
THE SUSPENDED MODULES CAN BE ASSEMBLED
TO CREATE PERSONALISED COMPOSITIONS



MIGUEL ARRUDA



NUVEM COMPOSITION, 5 MODULES, 3 SPOTLIGHTS.



NUVEM COMPOSITION, 7 MODULES, 4 SPOTLIGHTS.



**FÁBRICA
DAS PALAVRAS**

BIBLIOTECA MUNICIPAL
E EQUIPAMENTO CULTURAL



VILA FRANCA DE XIRA
PORTUGAL



INTERNATIONALLY PATENTED

"The product is designed to be easily combined, facilitating the assembly of large, complex structures while ensuring solidity, reliability, and safety during installation/use; easy to set up, competitive pricing."

[Extract from the 2019 patent of use]



SYSTEM COMPONENTS

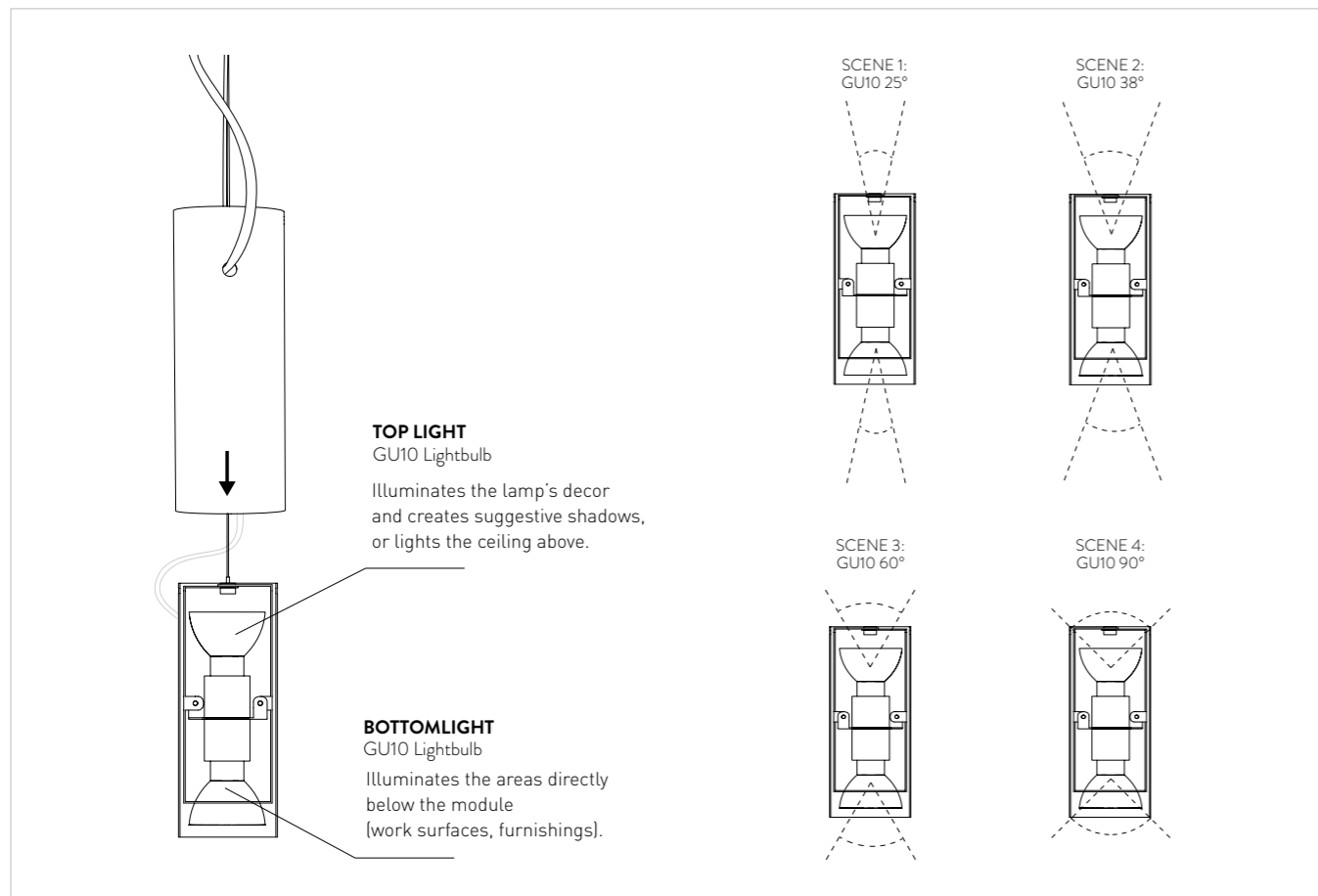
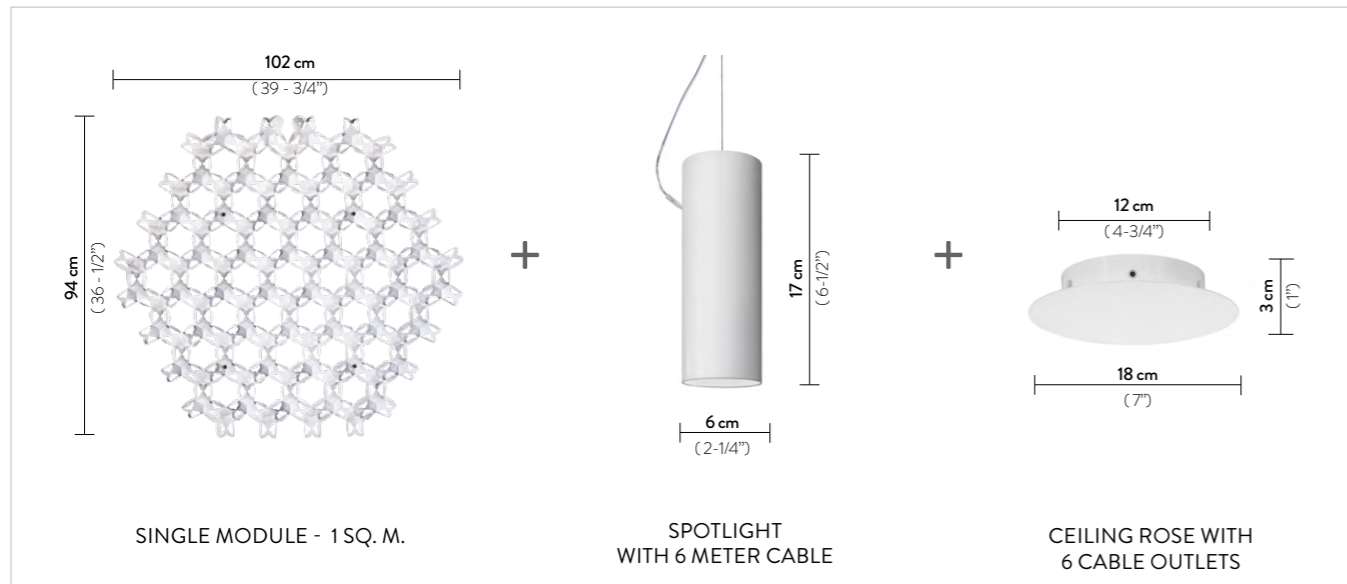

ADJUSTABLE HEIGHT

Nuvem's height can be adjusted using the 6 meter cable, and once suspended, the design can be "moulded" using the push and pull system located directly beneath each module. The lamp collapses or tenses when the wires are pushed (released) or pulled, giving the ceiling a fluctuating feeling.

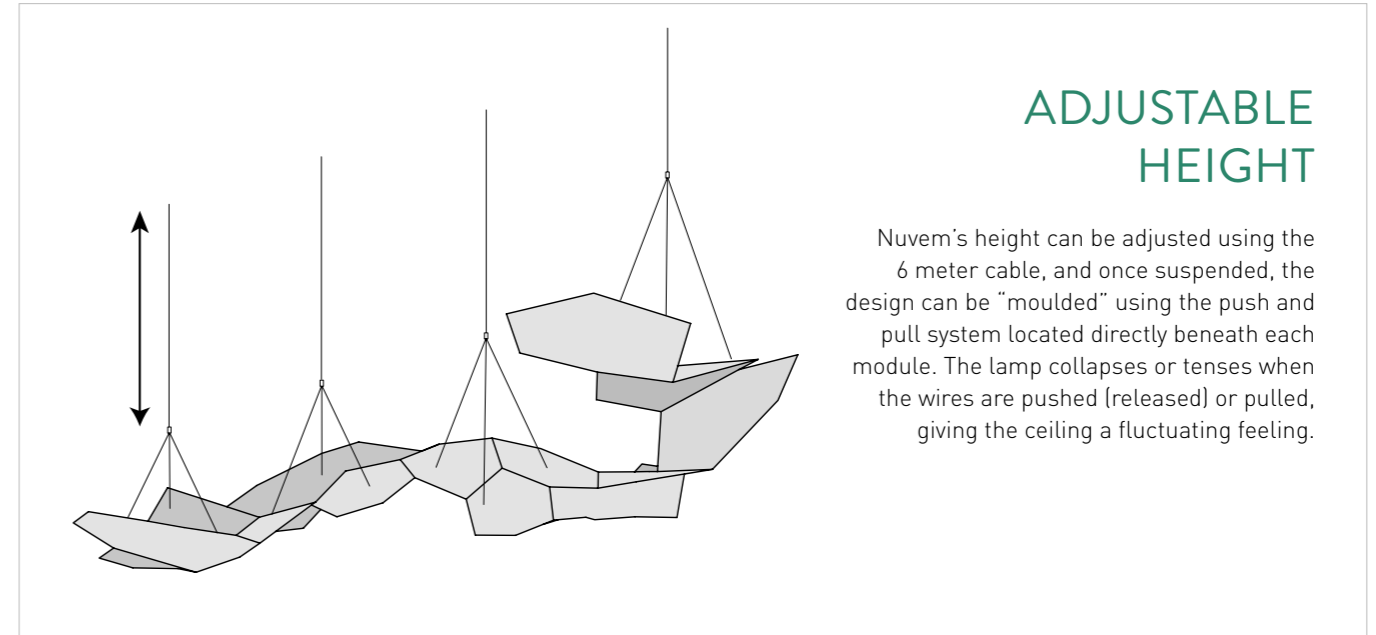

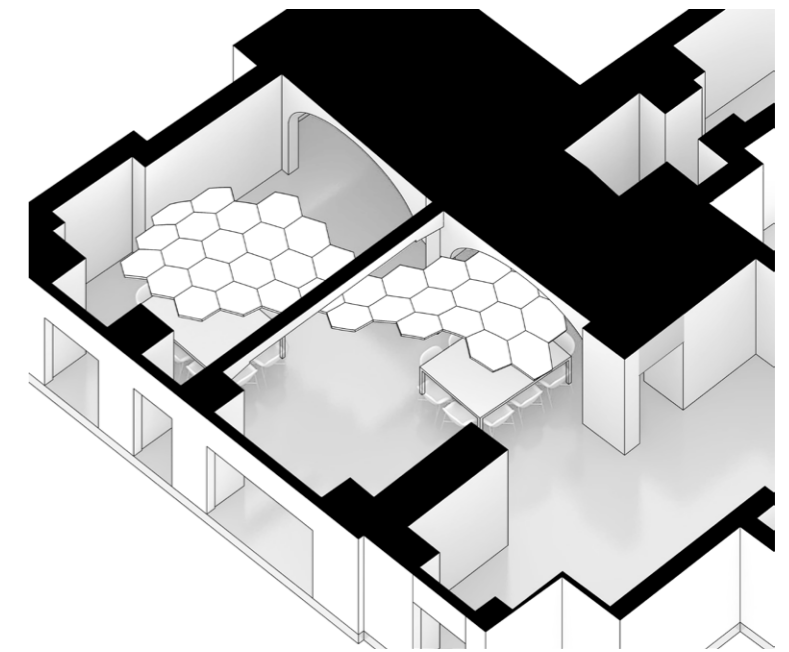

INTERIOR DECORATION SERVICES

OUR PROFESSIONAL LIGHTING TEAM IS ON-HAND TO HELP YOU DURING THE DESIGN PROCESS, PROVIDING YOU WITH THE NECESSARY TECHNICAL SUPPORT.

TECHNICAL DETAILS

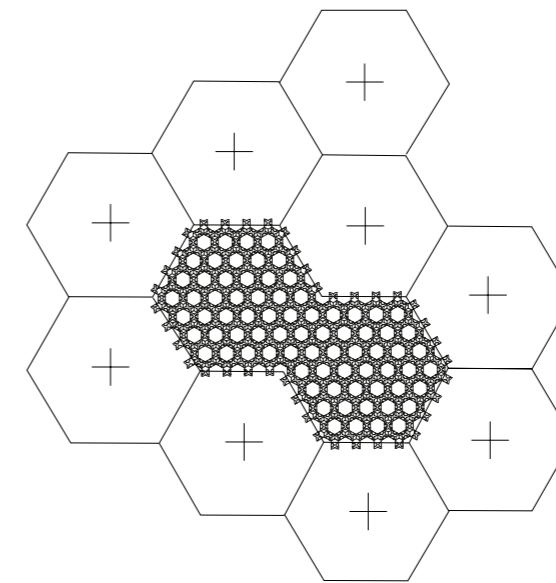

One sq. m. modules with bidirectional spotlights that can be infinitely combined

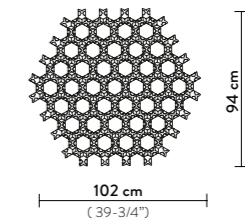

| MODULAR SUSPENSION | ADDITIONAL SPOTLIGHT | CANOPY |
|---|--|--|
| <p>2 X 8W GU10 PAR 16 LED</p> <p>Bidirectional Bulbs</p> | <p>2 X 8W GU10 PAR 16 LED</p> <p>Bidirectional Bulbs</p> | <p>1 canopy max 6 electric wires</p> |
| | | |
| <p>Made of: Opalflex®</p> <p>With: GU10 Bulbs on request, Standard cable Kit 6 m. Canopy not included</p> <p>Colour: <input type="checkbox"/> WHITE</p> | <p>Made of: Steel</p> <p>With: GU10 Bulbs on request, Standard cable Kit 6 m.</p> <p>Colour: <input type="checkbox"/> WHITE RAL 9016</p> | <p>Made of: Steel</p> <p>With: GU10 Bulbs on request, Standard cable Kit 6 m.</p> <p>Colour: <input type="checkbox"/> WHITE RAL 9016</p> |
| <p>Product Code: NUV96SIN0000WT000</p> | <p>Product Code: ACC00SPO000__NUV</p> | <p>Product Code: ACC000COP000__NUV</p> |

CANOPY DETAILS



NUVEM

Ø 18 / 12 cm x h. 3 cm (Ø 7" / 4-3/4" x h. 1")
La coppetta ospita fino 6 cavi elettrici
Canopy max 6 electric wires

CERTIFICATION

CE IP 20

ENERGY CLASS: A / A+ / A++
ENERGY LABEL AVAILABLE ON SLAMP'S WEBSITE

NUVEM ENTIRE COLLECTION

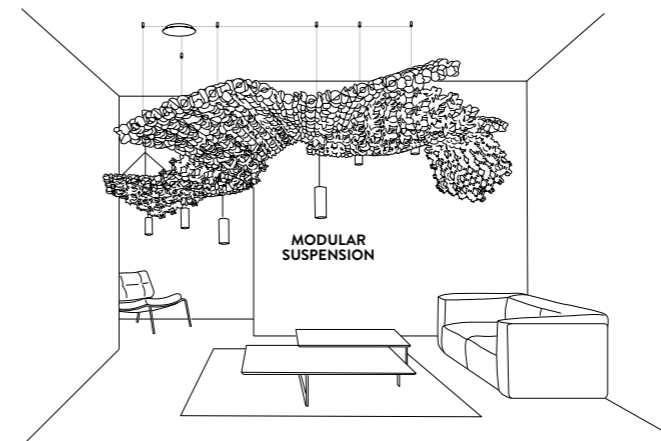

FINISHES



SLAMP S.P.A.

Via Vaccareccia 12/14 - 00071 Pomezia (Rome) Italy

Tel +39 06 9162391 - Fax +39 06 91623933

P. IVA 03600301000

www.slamp.com



SLAMP®
THE LEADING LIGHT